



**Clear Hills County  
Invites You To The  
28th Annual  
Agricultural Trade  
Show**

**Saturday, April 12, 2025**

**Dave Shaw Memorial Complex**

**Hines Creek, Alberta**

Dear Sponsor and Exhibitor,

We are excited to invite you to participate in our 28th Annual Clear Hills County Agricultural Trade Show!

This one day event will take place on Saturday, April 12, 2025 at the Dave Shaw Memorial Complex in Hines Creek, Alberta.

Whether your company is large or small, this event is an excellent business opportunity and will increase your visibility among the surrounding communities.

The Clear Hills County Agricultural Trade Show attracts rural families, agricultural producers and residents from surrounding areas; and supports local community groups and non-profit organizations.

Sponsors and Exhibitors are invited to promote their businesses and display their goods and services to the hundreds of people that pass through the door each year.

Please review the exhibitor options and sponsorship opportunities outlined in the enclosed package and submit your registration before March 31, 2025!

On behalf of the Clear Hills County Agricultural Service Board, we look forward to seeing you in April!

Regards,

Greg Coon  
Agricultural Fieldman

## **Have any questions? Contact our team!**

**Greg Coon**  
**780-685-3925 ext. 115**  
**greg@clearhillscounty.ab.ca**

***Booth Bookings:***  
**Natasha Gillett**  
**780-685-3925 ext. 108**  
**community@clearhillscounty.ab.ca**

# Sponsorship Opportunities

	<b>Platinum</b>	<b>Gold</b>	<b>Silver</b>	<b>Bronze</b>
<b>Recognition</b>	<b>\$3,000.00 &amp; Up</b>	<b>\$2,000.00</b>	<b>\$1,000.00</b>	<b>\$500.00</b>
Trade Show Events Handout to Visitors	Logo	Logo	Logo	Name
Listed in the County Newsletter	Logo	Logo	Logo	Name
Included in the Breakfast Placemats	Logo	Logo	Small logo	Name
Included in PowerPoint Presentation  *PowerPoint is ran all day	Logo  *1 sponsor per screen and multiple times per cycle	Logo  *2 sponsors per screen	Logo  *3 sponsors per screen	Name  *All bronze sponsors on one screen
Acknowledgement on PA System during the Trade Show	Yes  *Minimum once per half hour	Yes	Only for specific venue sponsorship	
Logo included in two newsletter ads prior to the trade show and on our Facebook Page	Yes	Yes		
Radio Advertisement  (If sponsored before March 1st)	Yes			

***Special thank you to past, present and future sponsors!***

# Exhibitor Information

## **Booth Setup:**

The following items are included for each exhibitor booth:

- ⇒ 2 Chairs
- ⇒ Table
- ⇒ Table Covering and Skirting
- ⇒ GST Included in pricing
- ⇒ Limited Additional Tables for \$25.00 each
- ⇒ Electrical Outlet (110V)
- ⇒ Indoor booths include back wall and side wall draping

*Draping colors are Green & Silver*

## **Standard Indoor Booths:**

10 ft. x 10 ft.

## **Indoor Machinery Booths:**

20 ft. x 20 ft.  
(approximately 400 square ft.)

## **Outdoor Machinery Booths:**

40x40ft

## ***Early Bird Registration***

Register before February 28, 2025 and qualify for the early bird registration price!

## ***Registration Deadline***

**March 31, 2025**

## ***Cancellation Terms***

Booth cancellations received after March 31st **may** be refunded up to 75% of the booth registration.

## **Insurance Requirements**

Exhibitors are informed that injury or damage occurring to the public or employees in their leased booths may be covered by Commercial General Liability Policy. It is the responsibility of each and every exhibitor to arrange their own insurance coverage and provide a Certificate of Insurance or proof of General Liability with liability of no less than \$2,000,000.00, naming Clear Hills County as an Additional Insured. Home Owners and Tenants Insurance will not be accepted unless you have a home based business extension in which case a Certificate of Insurance as above will be required. Clear Hills County assumes no responsibility for loss or damages to exhibitors displays, materials, supplies or other items at any time.

Another option for short term exhibitor insurance may be PAL Insurance Brokers Canada Ltd. Applications can be made online at [palcanada.com](http://palcanada.com) for exhibitor/vendor booth & Kiosk Liability Policy.

***Insurance requirements must be met to finalize booth registration.***

## Show Schedule

	Friday	Location
Spring Fair Entries accepted by the Hines Creek Agricultural Society	11:00 a.m.—2:00 p.m.	Community Hall
Exhibitor Booth Setup	1:00 p.m.—9:00 p.m.	
	Saturday	
Exhibitor Booth Setup	7:00 a.m.—8:30 a.m.	Using Back Entrance
Sponsored Breakfast	8:00 a.m.—10:00 a.m.	Fitness Centre
Trade Show	9:00 a.m.—4:00 p.m.	Fitness Centre, Arena Surface & Outdoors
Wagon Rides	10:00 a.m.—3:00 p.m.	
Hines Creek Spring Fair Exhibits	10:00 a.m.—2:00 p.m.	Community Hall
Hines Creek Arts & Crafts Club Display & Lunch	11:00 a.m.—4:00 p.m.	Upstairs above lobby
Presentation of Spring Fair Prizes	2:00 p.m.	Community Hall
Kids Talent Show	3:00 p.m.	Community Hall
Exhibitor Clean-up	4:00 p.m.—6:00 p.m.	

# Clear Hills County Agricultural Trade Show 2025

Dave Shaw Memorial Complex  
Hines Creek, AB

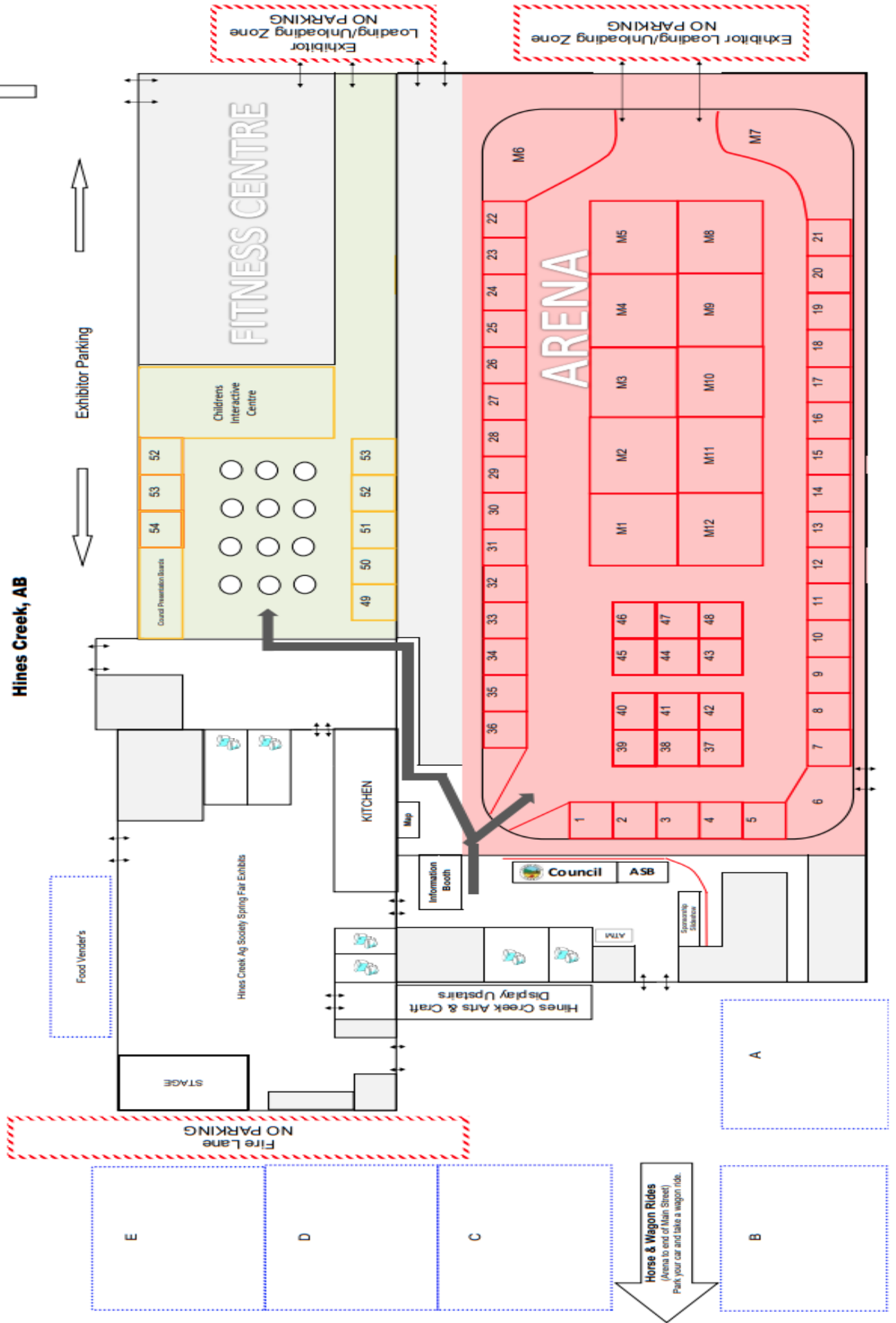
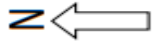

# Registration Form

April 12, 2025 Dave Shaw Memorial Complex, Hines Creek, Alberta

Company/Organizations: \_\_\_\_\_

Contact Name: \_\_\_\_\_

Address: \_\_\_\_\_ Postal Code: \_\_\_\_\_

Telephone No. \_\_\_\_\_ Cell: \_\_\_\_\_ Fax: \_\_\_\_\_

Email: \_\_\_\_\_

## Sponsorship

Platinum (\$3,000 & Up)  Gold (\$2,000)  Silver (\$1000)  Bronze (\$500.00)

## Exhibitors

**Deadline: March 31, 2025**

Booth	Early Bird Price (Before February 28th)	Price After February 28th Deadline	Quantity	Total
Standard Booth	\$150.00	\$200.00		\$
Indoor Machinery Booth (20x20ft)	\$350.00	\$400.00		\$
Outdoor Machinery Booth (40x40ft)	\$150.00	\$200.00		\$
Options: Additional Table	\$25.00	\$50.00		\$
Options: Additional Chairs	\$0.00	\$0.00		\$
Sponsorship				\$
				Total: \$

Booth No. Preferences: (List 3)

List of products or services you will be advertising/selling: \_\_\_\_\_

### Check List

- Registration Form
- Exhibitor Agreement (pg. 8)
- Payment
- Certificate of Insurance

### Payment information

Please mail cheque to:

Clear Hills County

Box 240

Worsley, Alberta

T0H 3W0

E-transfers can be sent to [payments@clearhillscounty.ab.ca](mailto:payments@clearhillscounty.ab.ca)

Please include TRADESHOW in the memo line.

We do not accept credit card payments by phone or email.

## Exhibitor Agrees to the following Terms & Conditions

1. Clear Hills County, in its sole discretion, reserves the right to assign, decline, and/or change booth locations without notice.
2. Clear Hills County, in its sole discretion, reserves the right to accept or reject any request to exhibit or participate in the show at any time.
3. Clear Hills County, in its sole discretion, reserves the right to reject, move or prohibit any exhibit in whole or in part or its representative if in the opinion of Show Management the exhibit or the activities the exhibitor or its representative violates the Agreement or is detrimental to the aims, goals and purpose of the show.
4. Clear Hills County prohibits any abusive conduct and inappropriate behaviour toward Show Management, attendees, guests or any affiliated representative of the show.
5. Clear Hills County does not assume responsibility for any loss, damages and/or theft of exhibitor's displays, materials, supplies, etc. Security will be onsite during the entire show.
6. Exhibitor's will hold Clear Hills County harmless for any damage, expense, or liability arising from any injury or damage to said exhibitor, its agents, servants or employees, resulting from any acts or omissions of the exhibitor, its agents, employees or representatives, for which the exhibitor is legally responsible for.
7. Exhibitors are entirely responsible for leased space and agree to reimburse for any damage to property, facilities, furnishings, or equipment occurring on the premises of the event, providing such damage is due to negligence of the exhibitor, its servants, agents or others for whom the exhibitor is, by law, responsible for.
8. Exhibitors are required to provide a valid Certificate of Insurance for the event and booth rental.
9. Exhibitors materials, supplies, equipment, displays, materials, supplies etc. must not be extended beyond the exhibitor's designated booth space.
10. The exhibitor agrees to remove the exhibit, equipment, displays, materials, supplies, etc. from the show building between the hours of 4:00 p.m. and 6:00 p.m. on the day of the show.
11. Clear Hills County has the authority to establish and interpret rules and regulations necessary for the orderly conduct of exhibitors and/or agents for the mutual benefit of all parties.

I, \_\_\_\_\_ (please print) have read, understand and agree to the terms and conditions stated above.

Position/Title: \_\_\_\_\_

Company/Organization: \_\_\_\_\_

Signature: \_\_\_\_\_ Date: \_\_\_\_\_